

Amazing 中国
CHINA 中国

8D6N
CRUISING THE THREE GORGES
WITH HUAXIA RIVER CRUISE /
CHONGQING / WUHAN
长江三峡（华夏游轮）/ 重庆 / 武汉

Tour Code: PCYTC-3



China
中国



Wuhan
武汉



Chongqing
重庆



Three Gorges Dam
三峡大坝

SPECIAL ARRANGEMENTS 特别安排

- ✓ Hua Xia Goddess No. 3 (2021 Launched 5-Star Cruise Ship) Terrace Room
华夏神女三号（2021年启航5星级游轮）露台房
- ✓ Five-Star Hotel: Chongqing Jin Yi Howard Johnson Hotel or similar
五星级酒店：重庆锦怡豪生酒店或同级
- ✓ Three Gorges Dam Ship Lift
三峡大坝升船机
- ✓ Special Meal: Chongqing Hotpot
特色餐：重庆鸳鸯火锅
- ✓ Wuling Mountain Grand Canyon (Including downhill cableway)
武陵山大裂谷（含下行索道）
- ✓ Cruise Exploration Bar VIP Lounge: Unlimited coffee, juice, soft drinks, tea, and beer
游船观景探索吧VIP休息室：无限畅饮咖啡、果汁、饮料、茶、啤酒
- ✓ Tribe of the Three Gorges (China's first original ecological, immersive folk culture tourism area)
三峡人家（中国首创原生态场景式体验型民俗旅游区）

*Remarks: All photos in the itinerary are for illustration purpose only. *备注：行程上的图片仅供参考。



Mount Wuling Great Rift Valley
武陵山大裂谷



Cinema 电影院



Chongqing Hotpot 重庆鸳鸯火锅



Restaurant 中餐厅



Hua Xia Goddess No.3 Reception 华夏神女三号前台



HUAXIA CRUISES
华夏游轮

SPECIFICATIONS

Star Rating 星级标准	: Five-Star 五星级 CCS Green Ship CCS 绿色船舶
Maiden Voyage Date 首航日期	: May 20, 2021 2021年5月20日
Cruise Tonnage 游轮吨位	: 16,000 tons 16000 吨
Hull Length 船体长度	: 149.9 meters 149.9 米
Hull Width 船体宽度	: 23.2 meters 23.2 米
Passenger Capacity 载客人数	: 650 people 650 人
Number of Decks 甲板层数	: 7 levels 7 层



CRUISE CABIN TYPE



Deluxe Suite 豪华套房



Standard Balcony 豪华阳台标准间



Family Suite 亲子套房



Wu Gorge, Qutang Gorge 巫峡、瞿塘峡



Wuhan Gude Temple 武汉古德寺



Ciqikou Ancient Town 磁器口古镇



精简行程

第一天 槟城 ✈️ 中转城市 ✈️ 武汉 (机上用餐)

第二天 抵达武汉 (早/午/晚)

- ✓ 武汉黄鹤楼 (含门票、电瓶车)
- ✓ 江汉路步行街

第三天 武汉 - (330公里) 宜昌 (早/午/晚)

- ✓ 古德寺 (含门票)
- ✓ 黎黄陂路
- ✓ 木鱼岛
- ✓ 宜昌茅坪码头登船
- ✓ 游船安全说明会

第四天 长江三峡 (早/午/晚)

- ✓ 三峡大坝 (含景区电瓶车)
 - ✓ 三峡大坝升船机
 - ✓ 三峡人家 (中国首创原生态场景式体验型民俗旅游区)
- *享用船长欢迎酒会**

第五天 长江三峡 (早/午/晚)

- ✓ 巫峡、瞿塘峡
 - ✓ 晚间文艺表演
- *游船可选择性自费项目 (一):**
巫山小三峡 (换小船游览) (人民币180/人)
- *游船可选择性自费项目 (二):**
奉节白帝城 (人民币290/人)

第六天 长江三峡 (早/午/晚)

- ✓ 上岸游览“丰都雪玉洞”
- ✓ 武陵山大裂谷 (含下行索道)

第七天 长江三峡 - 重庆 (早/午/晚)

- ✓ 磁器口
- ✓ 解放碑步行街、八一路好吃街
- ✓ 洪崖洞

第八天 重庆 ✈️ 中转城市 ✈️ 槟城 (早/机上用餐)

- ✓ 李子坝轻轨穿楼观景台

旅游亮点:

长江三峡

- ◆ **长江三峡** - 长江三峡位于中国重庆和湖北之间, 是中国最壮丽的自然奇观之一。三峡由瞿塘峡、巫峡和西陵峡组成, 全长约193公里。这里以其陡峭的悬崖、壮观的峡谷和丰富的文化历史而闻名, 同时也是三峡大坝所在地。这一地区融合了自然美景与工程奇迹, 是游客探索中国自然和文化遗产的必游之地。其陡峭的悬崖、壮观的峡谷和丰富的文化历史而闻名, 同时也是三峡大坝所在地。这一地区融合了自然美景与工程奇迹, 是游客探索中国自然和文化遗产的必游之地。

华夏神女三号

- ◆ **华夏神女三号** - 长江三峡游轮系列中的高端豪华游轮, 以其现代化的设计和卓越的服务品质而闻名。游轮设有宽敞的江景露台房, 为游客提供绝佳的观景体验。船上配备一流的设施, 包括自助餐厅、酒吧、健身房和娱乐活动场所, 让游客在探索三峡美景的同时享受舒适与便捷。

重庆

- ◆ **洪崖洞风景区** - 以巴渝传统建筑特色的‘吊脚楼’风貌为主体, 古老的石头建筑和夜晚的灯光秀而闻名, 融合了传统文化和现代艺术元素。这个景区拥有悠久的历史, 曾是古代重庆的要塞, 同时也代表了现代文化的发展。
- ◆ **磁器口古镇** - 有千年历史, 以陶瓷制作和古老建筑著名, 是人文荟萃, 风景优美, 独有‘一江两溪三山四街’地貌的旅游胜地, 在这里感受到深厚的古老文化气氛, 重温老重庆旧梦的好去处。
- ◆ **李子坝轻轨站观景台** - 为游客打造宽敞舒适, 最佳观看视角的观景台, 在这里‘打望’热门景观 - 轻轨穿楼。李子坝站为高架车站, 是重庆唯一的楼中车站, 位于一栋19层建筑物的六楼至八楼, 以下楼层是商铺, 以上则是住宅。



✓ 6早餐/5午餐/6晚餐

风味餐:

★ 游船自助餐

★ 鸳鸯火锅

★ 重庆风味



酒店住宿 (6晚)

✓ 武汉几诺酒店或同级

x1晚

✓ 华夏神女三号 (江景露台房) 或同级

x4晚

✓ 重庆锦怡豪生酒店或同级

x1晚

重要提示: 所有停靠港之启航/抵达/停靠时间会按航行情况有所调整/更改/取消, 以邮轮公司最后安排为准。

免责声明: 由于当地/宗教节日, 公众假期, 天气。交通等状况, 自然灾害, 必要时黄金旅游程保留对行程进行适当调整 (调整景点游览顺序) 以确保行程顺利进行, 会或否事先通知。

备注: 如果旅游行程受到上述问题的影响, 将不予退款或更换。

**如中英文版本有差异之处, 以中文版本为准。

**行程上的图片仅供参考。



Three Gorges Dam Ship Elevator 三峡大坝升船机



Chongqing Hotpot 重庆火锅



Jiefangbei Pedestrian Street 解放碑步行街



SCHEDULE

D1 PENANG ✈️ TRANSIT CITY ✈️ WUHAN (MOB)**D2 ARRIVE IN WUHAN** (-/L/D)

- ☑ Yellow Crane Tower in Wuhan (Including entrance ticket and buggy)
- ☑ Jiangnan Road Pedestrian Street

D3 WUHAN – (330km) YICHANG (B/L/D)

- ☑ Gude Temple (including entrance ticket)
- ☑ Lihuangpi Road
- ☑ Muyu Island
- ☑ Board the cruise at Yichang Maoping Pier
- ☑ Cruise safety briefing

D4 YANGTZE RIVER THREE GORGES (B/L/D)

- ☑ Three Gorges Dam (Includes Scenic Area Buggy Services)
- ☑ Three Gorges Dam Ship Elevator
- ☑ Three Gorges Tribe (China's first original ecological, immersive folk culture tourism area)

*Enjoy the Captain's Welcome Reception

D5 YANGTZE RIVER THREE GORGES (B/L/D)

- ☑ Wu Gorge, Qutang Gorge
 - ☑ Evening cultural performance
- *Optional self-paid excursion 1: Lesser Three Gorges (small boat tour) (RMB 180/person)
- *Optional self-paid excursion 2: White Emperor City in Fengjie (RMB 290/person)

D6 YANGTZE RIVER THREE GORGES (B/L/D)

- ☑ Shore excursion: Fengdu Snow Jade Cave
- ☑ Wuling Mountain Grand Canyon (including descending cable car)

D7 YANGTZE RIVER THREE GORGES – CHONGQING (B/-/D)

- ☑ Ciqikou Ancient Town
- ☑ Jiefangbei Pedestrian Street and Bayi Road Gourmet Street
- ☑ Hongya Cave

D8 CHONGQING ✈️ TRANSIT CITY ✈️ PENANG (B/MOB)

- ☑ Liziba Light Rail Through-Building Viewing Platform

TOURIST ATTRACTIONS:

YANGTZE RIVER THREE GORGES

- ◆ **Yangtze River Three Gorges** - Comprised of Qutang Gorge, Wu Gorge, and Xiling Gorge, it stretches approximately 193 kilometers. Renowned for its steep cliffs, spectacular canyons, and rich cultural history, it is also home to the Three Gorges Dam. This region combines natural beauty with engineering marvels, making it a must-visit destination for exploring China's natural and cultural heritage.

THE CENTURY GODDESS NO. 3

- ◆ **The Century Goddess No. 3** - A premium luxury cruise ship in the Yangtze River Three Gorges series, renowned for its modern design and exceptional service quality. The cruise offers spacious riverscape balcony rooms, providing guests with unparalleled scenic views. Onboard facilities include a buffet restaurant, bar, gym, and entertainment venues, ensuring a comfortable and convenient experience while exploring the breathtaking Three Gorges.

CHONGQING

- ◆ **Hongyadong Scenic Area** - Featuring the traditional architectural style of "hanging wooden houses" characteristic of Ba-Yu, famous for its ancient stone buildings and nighttime light shows, blending traditional culture with modern artistic elements.
- ◆ **Ciqikou Ancient Town** - With a history of thousands of years, famous for its ceramics production and ancient architecture, it is a place where humanities converge, boasting beautiful scenery and unique geographical features of "one river, two streams, three mountains, four streets."
- ◆ **Liziba Light Rail Station Viewing Platform** - A spacious and comfortable viewing platform designed for tourists to have the best viewing angle, where you can "look over" the popular sight of the light rail passing through buildings. Liziba Station is an elevated station, the only one in Chongqing located within a 19-story building from the sixth to eighth floors. Below are shops, while above are residential areas.



✓ 6 Breakfasts / 5 Lunches / 6 Dinners

Special Cuisines:

- ★ Cruise Buffet
- ★ Chongqing Local Flavors
- ★ Yuanyang Hotpot



HOTEL OR SIMILAR (6 NIGHTS)

- ✓ Wuhan Jinuo Hotel or similar x 1 Night
- ✓ Century Goddess No. 3 Cruise (Riverscape Balcony Room) or similar x 4 Nights
- ✓ Chongqing Howard Johnson Jinji Hotel or similar x 1 Night

Important Note: Cruise line reserves the right to make changes on itinerary, timing etc on all embarkations/disembarkations, and port(s) of call cancellation due to weather condition or specific reasons.

Disclaimer: Due to Local/Religious festivals, Public holidays, Weather condition, Acts of nature, Transport technical issue & etc; Golden Destinations reserves the right to alter the sequence or change, amend or alter the itinerary if necessary, with or without prior notice.

Remark: There will be no refund or replacement if the tour logistic affected by the above issue.

**If there is any inconsistency or conflict between English and Chinese version, the Chinese version shall prevail.
**All photos in the itinerary are for illustration purpose only.

1楼-主甲板 | 1 楼

Deck 1 - Main Deck | Deck 1

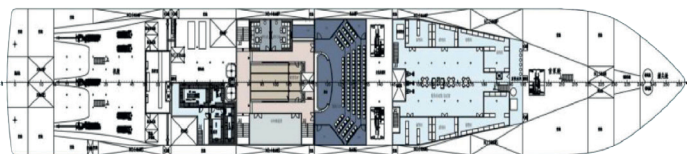
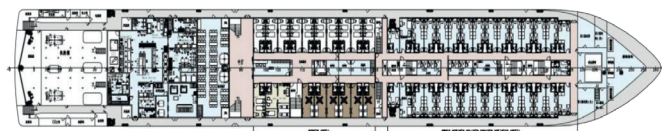

1楼-主甲板

- 棋牌室
- 医务室
- 乘警室

Deck 1 - Main Deck

- Chess and Card Room
- Medical Room
- Security Office

1楼

- 电影院
- KTV包房
- 电玩城

Deck 1

- Cinema
- KTV Private Rooms
- Arcade

4楼甲板 | 3楼-游步甲板 | 2楼-上甲板

4th Floor Deck | 3rd Floor-Promenade Deck | 2nd Floor-Upper Deck

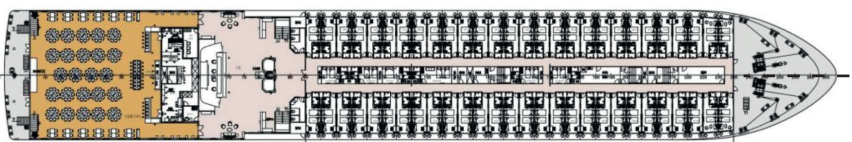
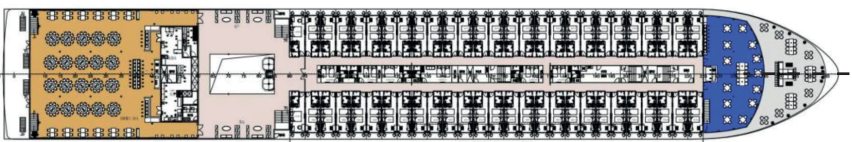
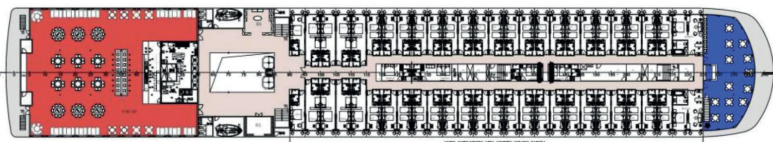

4楼甲板

- 标准间
- 内舱房
- 豪华套房
- 家庭亲子房
- 探索吧
- VIP餐厅
- 特产超市
- 珠宝店

4th Floor Deck

- Standard Room
- Interior Cabin
- Family Room (Parent-Child Friendly)
- Luxury Suite
- Exploration Bar
- VIP Restaurant
- Specialty Supermarket
- Jewelry Store

3楼-游步甲板

- 标准间
- 内舱房
- 探索吧
- 餐厅
- 服装店

3rd Floor - Promenade Deck

- Standard Room
- Interior Cabin
- Exploration Bar
- Restaurant
- Clothing Store

2楼-上甲板

- 标准间
- 内舱房
- 游轮前台
- 摄影中心
- 餐厅

2nd Floor - Upper Deck

- Standard Room
- Interior Cabin
- Cruise Reception
- Photography Center
- Restaurant

7楼-顶层甲板

7th Floor – Top Deck

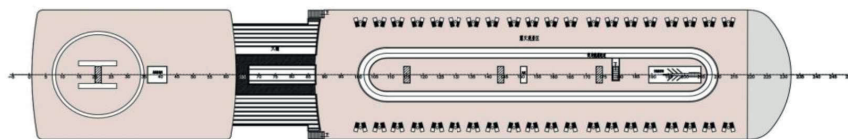

7楼-顶层甲板

- 停机坪
- 慢跑道

7th Floor – Top Deck

- Helipad
- Jogging Track

6楼-阳光甲板

6th Floor – Sun Deck

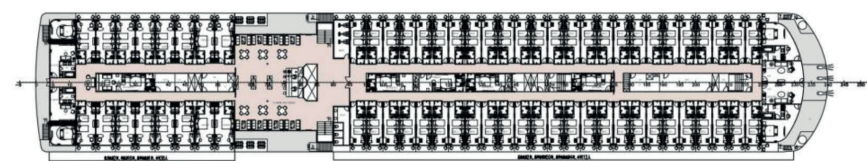

6楼-阳光甲板

- 标准间
- 星空套房
- 行政房
- 行政休息区
- 总统套房
- 健身房

6th Floor – Sun Deck

- Standard Room
- Starry Sky Suite
- Executive Room
- Executive Lounge
- Presidential Suite
- Gym

5楼-驾驶甲板

5th Floor – Navigation Deck

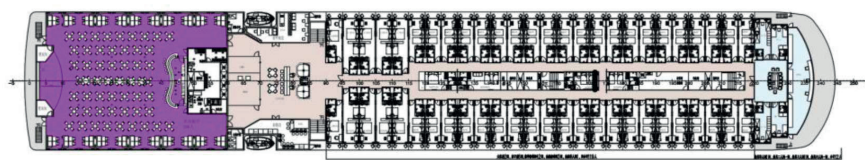

5楼-驾驶甲板

- 标准间
- 内舱房
- 家庭亲子房
- VIP 接待区
- 儿童乐园
- 美容美发
- 多功能厅
- 驾驶室

5th Floor – Navigation Deck

- Standard Room
- Interior Cabin
- Family Room
(Parent-Child Friendly)
- VIP Reception Area
- Children's Playground
- Beauty and Hair Salon
- Multi-Function Hall
- Bridge/Control Room



HUAXIA CRUISES
华夏游轮

General Information

· 重庆 + 武汉 CHONGQING + WUHAN ·



货币 Currency 	Chinese Yuan - CNY Renminbi - RMB 中国元 - CNY 人民币 - RMB	信用卡 Credit Card 	* 致电信用卡中心，以延长你的信用卡额度 * Major credit cards such as Visa and Master card are mostly widely used
货币兑换率 Exchange Rate 	10 CNY = MYR 6.20 10 元 = 马币 6.20 <small>*Subject to currency of the day* *以当天汇率为准*</small>	拨号代码 Dial Code 	China : +86 中国 : +86
电压 Voltage 	Voltage - 220 V 电压 - 220伏特	插座 Power Socket 	类型 / Type A - 两脚扁型插头 / 2 flat blade pin 类型 / Type B - 两脚扁型 + 一圆型插头 / 2 flat blade pin + 1 round pin 类型 / Type I - 八字扁型脚+接地孔 / 3 Oblique flat blade pin "V-shape"
时差 Time Different 	China - No time difference with Malaysia 中国 - 时间与马来西亚时间标准时无相差	行李托运 Luggage Allowance 	Each individual are entitled to check in 1 luggage of not more than 23 kg and a hand carry bag not more than 7 kg. 每人只限携带一件不超过7公斤的手提行李上机，以及托运行李不超过23公斤。
气候 Weather 	<input type="checkbox"/> Spring 春季 3月 - 5月 Mar to May 1°C ~ 27°C <input type="checkbox"/> Summer 夏季 6月 - 8月 Jun to Aug 21°C ~ 30°C <input type="checkbox"/> Autumn 秋季 9月 - 11月 Sep to Nov 0°C ~ 26°C <input type="checkbox"/> Winter 冬季 12月 - 2月 Dec to Feb -5°C ~ 10°C <small>*Subject to weather of the day* *以当天天气报告为准*</small>		
飞机型号 Aircraft Type 	 A330 / A321		

Departure Date: 出发日期:	<input type="text"/>	Flight : 航班行程:	<input type="text"/>
Tour Fare: 团费:	<input type="text"/>	Airport Tax & Fuel Surcharge: 机场税及燃油附加费:	<input type="text"/>
Tipping: 小费:	<input type="text"/>	Agent Collection Fee: 旅行社代收费:	<input type="text"/>
Visa: 签证:	<input type="text"/>	Travel Insurance: 旅行保险:	<input type="text"/>
		TOTAL : 总数:	<input type="text"/>



Operated By
ICE HOLIDAYS SDN BHD
(230643-X) KPK/LN:2441

GD Partner: